

Compriband-R3-MF

Multifunctional tape with barrier membrane.
High-end tape: 3 levels – according to RAL.

compriband
wir machen dicht!



Product information

One tape for all functional areas in the window movement joint:
Compriband-R3-MF is a pre-compressed multifunctional tape made of PUR soft foam equipped with a barrier membrane. It is both extremely airtight and driving rain-proof and has very good thermal insulation properties. This makes it ideal for sealing window and door connections in accordance with the requirements of DIN18542:2020, the EU Building Directive and the Building Energy Act 2020, while at the same time meeting the stringent specifications for passive houses and zero-energy houses. Thanks to the integrated BARRIERE technology, the tape creates a safe demarcation of the different levels in the joint and leads to a reliable separation of the indoor and outdoor climate. It thus complies with the principle of "tighter on the inside than on the outside".

Roomside/interior:	air tight according to DIN18542:2020.
Insulation level:	acoustic- and thermal-insulation.
Weather side/outside:	consistent against wind and driving rain, vapor permeable.

Areas of Application

Compriband-R3-MF is a new specially impregnated, pre-compressed multifunctional tape for air and driving rain sealing and insulation of window movement joints. Special zones in the tape ensure sealing according to the principle "tighter on the inside than on the outside". The side surface of the inside of the tape is color-coded for better differentiation and must always face the inside of the room.

Examples of Application

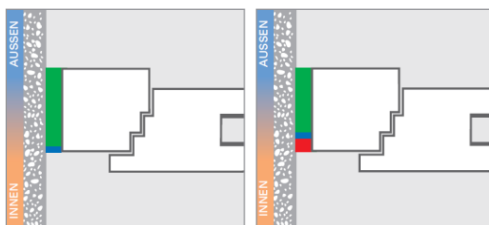

Product advantages

- High cost advantage due to time savings during installation:
 - one sealing tape is sufficient.
 - no further operations.
- Absolutely airtight due to barrier technology.
- Reliable separation of the 3 levels in the joint.
- EMICODE® tested, very low emission (EC1PLUS) certified.
- Sealing according to DIN18542:2020, EU Building Directive as well as Building Energy Act 2020 - inside color-coded.
- Simple and safe window sealing during installation in just one work step.
- Corresponds to the principle "inside tighter than outside".
- Driving rain tight ≥ 750 Pa.
- Installation independent of weather conditions.

* The properties and characteristics are depending on the compression of the tape. For application and installation-instruction please refer to separate instruction sheet.

Colour

- Black (the inside is marked in colour)

Delivery Form

- Pre-compressed rolls (see table with tape dimensions and roll lengths)

Compriband-R3-MF

Multifunctional tape with barrier membrane.
High-end tape: 3 levels – according to RAL.

Technical Data¹

Basis of Foam	Polyurethane cellular foam	
Basis of Impregnation	Acrylic resin with flame retardant	
Properties	Classification	Norm
Coefficient of Drain Capacity	$a \leq 0,1$ [m ³ /(h.m.(daPa) ^{0,5})]	DIN EN 12114
Watertight against Driving Rain	≥ 750 Pa	DIN EN 1027
Service Temperature	-30 °C to +80 °C	
Compatibility with other Building Materials	Requirements met	DIN 18542:2020
Thermal Conductivity	$\lambda_{10, tr} \leq 0,048$ W/m·K	DIN EN 12667
Building Classification/Flame Resistance	B1 (hardly inflammable)	DIN 4102
Classification	MF1 and MF2	DIN 18542:2020
U-value, Window Depth 60mm / 70mm / 80mm	$U = 0,8$ W/(m ² ·K) / $0,7$ W/(m ² ·K) / $0,6$ W/(m ² ·K)	DIN 4108-3
Soundproofing	Up to 58 dB	DIN EN ISO 12572
Sd-value Gradient (inside to outside)	Requirements met	
Storing Period	1 year at room temperature at 1 °C to 20 °C, in original packaging	

Tape Dimensions/Delivery Form² (further dimensions on request)

Dimension (mm)	Joint Width (mm)	Tape Width/ Joint Depth (mm)	Roll Length (m)	Box (m) (preliminary)
4-11x30	4-11	30	30	300
4-11x40	4-11	40	30	210
4-11x54	4-11	54	10	50
4-11x64	4-11	64	10	40
4-11x74	4-11	74	10	40
4-11x84	4-11	84	10	30
6-17x30	6-17	30	20	200
6-17x40	6-17	40	20	140
6-17x54	6-17	54	15	75
6-17x64	6-17	64	15	60
6-17x74	6-17	74	15	60
6-17x84	6-17	84	15	45
9-24x30	9-24	30	15	45
9-24x40	9-24	40	15	105
9-24x54	9-24	54	10	50
9-24x64	9-24	64	10	40
9-24x74	9-24	74	10	40
9-24x84	9-24	84	10	30

Application

Tools: For installation of the tapes get a measuring tape, knife / scissors and a spatula.

Surface treatment of the joints: Dirt, oil, fat, old sealing material and mortar residues have to be removed from the joint flanks.

Determination of the dimensions of the tape: Measure the window construction depth and the joint width (including tolerances and movement of the joint) and choose the correct dimension of the tape. In order to guarantee the required sealing effect of the installed tape, the prescribed areas of application (joint widths) of the individual tape dimensions may not be exceeded. The joint width has to be according to the dimensions of the tape (see table and price list). For tight joints, it is advantageous to moisten the tape.

Preparation of the tape (the side marked in colour showing to the middle of the room):

By cropping the tape please note the addition of at least 1 or 2 cm per meter. Cut off the piece of the beginning and the end of the roll. Remove the cover of the adhesive film and stick the pre-compressed tape on top of the clean and dry window frame. Start at the side of the frame with sticking up the tape on the bottom and then work upwards. Push the adhesive side tight against the component. It should be ensured that the tape is not elongated. As the tape changes its length after some time to the original length, light upsetting is advisable - otherwise leaks could arise. Press the tape at the upper frame against the horizontally bonded tape and stick out on each side along the tape the maximum of the joint width. The tape must not be applied in one piece around the frame. For safety reasons the tape must be laid offset at least 2 mm on both sides inwards from the leading edge of the joint.

Expansion-behavior: Only the delayed decompression enables the installation. The expansion-behavior of the tape depends on the joint and the ambient temperature. At higher temperatures, the material returns relatively fast (the component must be installed quickly). Therefore storage >20°C should be avoided over a prolonged period (the tape should not be stored directly in the sun). At lower temperatures under 1°C, we recommend to store the material at temperature of about 1°C to 20°C at least for 24 hours. The immediate expansion of the tape can be accelerated by heating with a hot air gun (in pivoting movements).

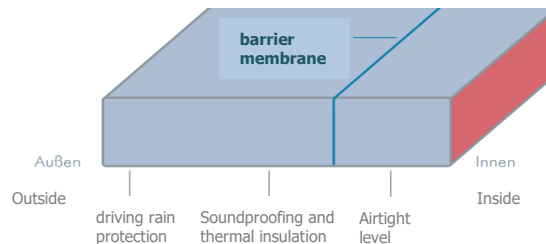

Abutting points of the tape: The individual tape lengths may be extended during the application by compressing the tailored tapes against each other. Joints or imperfections can be compensated with a suitable sealant

Instructions: The correct functioning of the tape can be achieved only under the condition if the tape is installed in accordance with our latest processing instructions, or has not applied and not been exposed to any unforeseeable influences for us. Decomposition caused by external effects is not covered by the warranty.

Decisive for the acceptance of a possible warranty claim: The professional processing by said standards and compliance with the processing instructions. Standing water or permanent water wetting cannot be permanently compensated by the product and is not a reason for complaint/claim. All commitments are relating to the use of the product at the Central European climate conditions. Before mounting read the manufacturer's processing instructions. If the manual is not available, contact the manufacturer or reseller. The technical data are subject to change with the degree of compression.

¹The correct functioning of the tape can be achieved only under the condition if the tape is installed in accordance with our latest processing instructions, or has not applied and not been exposed to any unforeseeable influences for us. Decomposition caused by external effects is not covered by the warranty. Decisive for the acceptance of a possible warranty claim: The professional processing by said standards and compliance with the processing instructions. Standing water or permanent water wetting cannot be permanently compensated by the product and is not a reason for complaint/claim. All commitments are relating to the use of the product at the Central European climate conditions. Before mounting read the manufacturer's processing instructions. If the manual is not available, contact the manufacturer or reseller. The technical data are subject to change with the degree of compression.

²Component movements and temperature-dependent changes in length are to be added to the existing joint widths. Dimensional tolerance according to DIN 7715 P3.